

INSTALLATION INSTRUCTIONS

10FT Large Portable Light Box

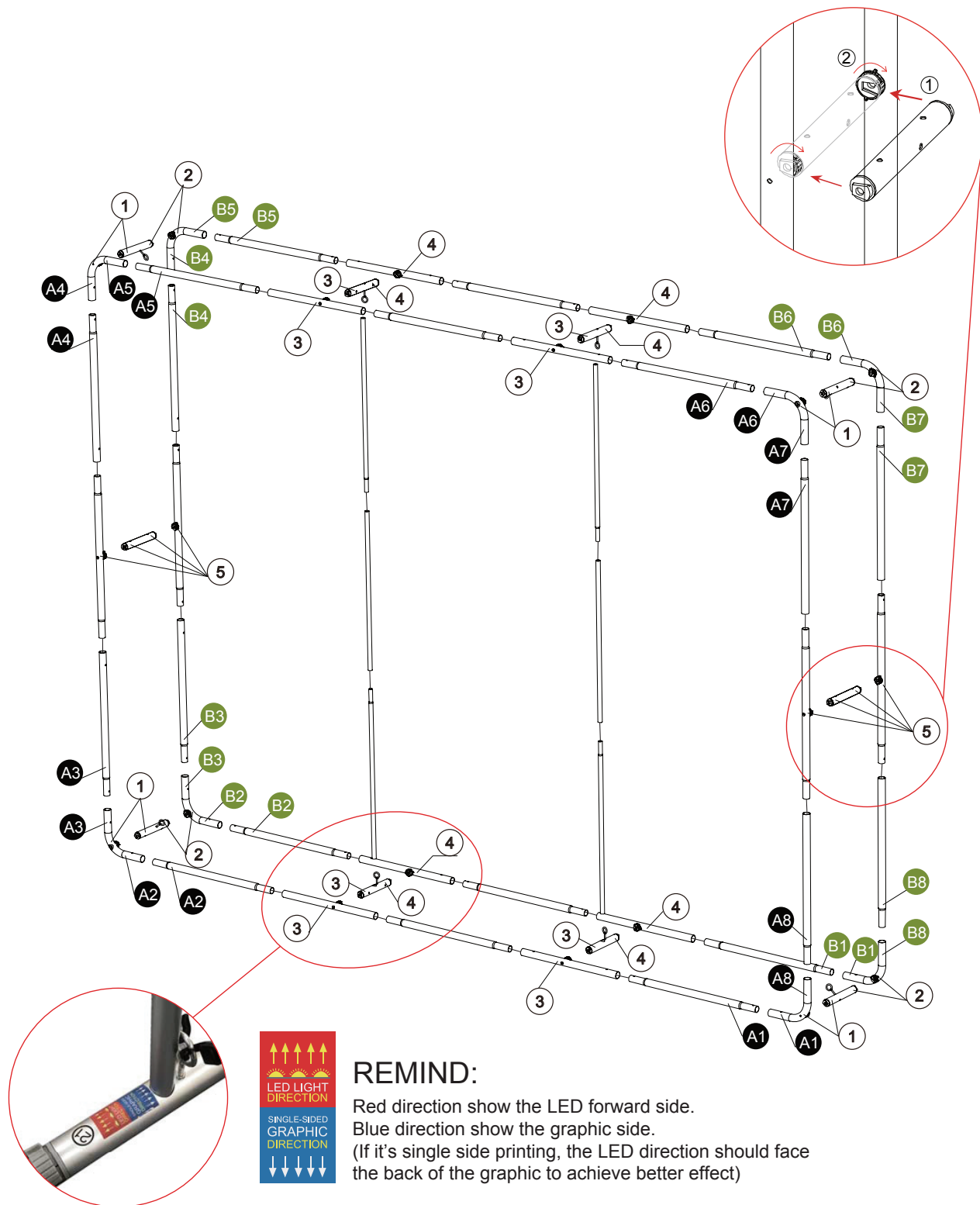

REMINDE:

Red direction show the LED forward side.
Blue direction show the graphic side.
(If it's single side printing, the LED direction should face the back of the graphic to achieve better effect)

Attention:

Please switch the LED panels progressively after assembly, this helps avoid an overload of electrical currents. If all the lights are switched at once, then potential damage to the LED panel.

EXPOMART

PORTABLE • MODULAR • BETTER

www.exposmart.co.il

INSTALLATION INSTRUCTIONS

10FT Large Portable Light Box

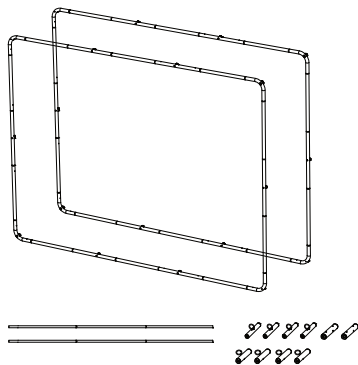

Put both horizontal tube connect with same label in to a frame, as the picture shown, and prepared the middle tube

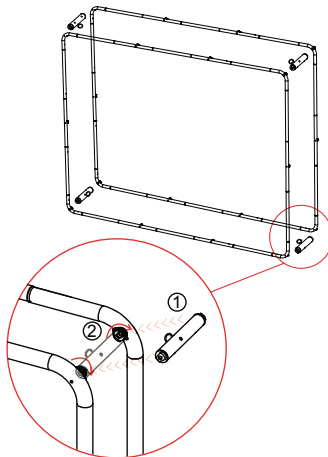

Go four horizontal corners firstly with the middle connector.

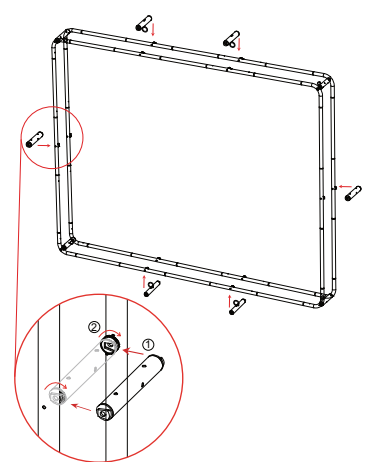

Install the rest horizontal connectors

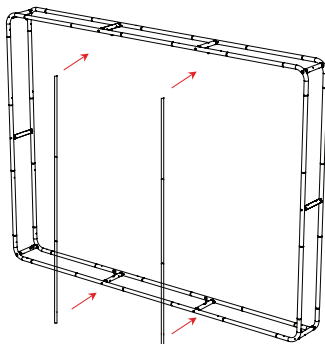

Install the middle tube to finish the frame

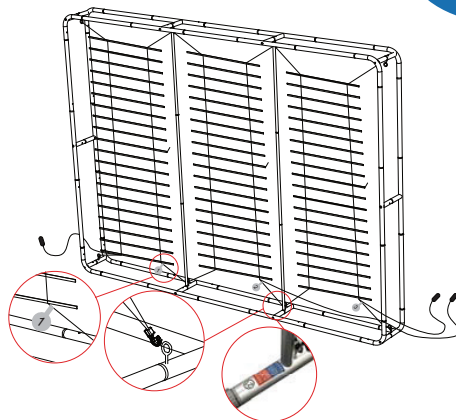

Hang the LED light into the frame sequentially, beware the direction of the LED panel

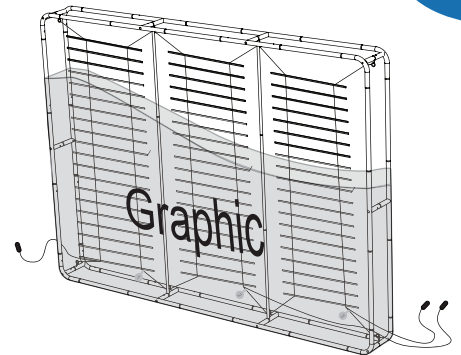

Set up graphic to the frame. (Light power line should be out from holes in graphic; If it's single side printing, the LED direction should face the back of the graphic to achieve better effect)

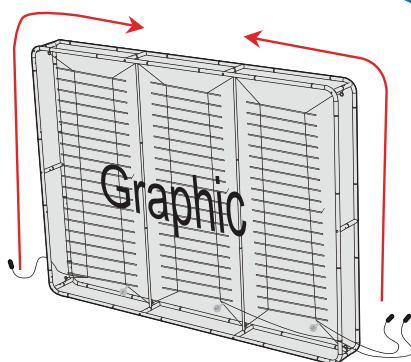

Zip the zipper. Fix the whole frame into the base and lock the slider with allen key

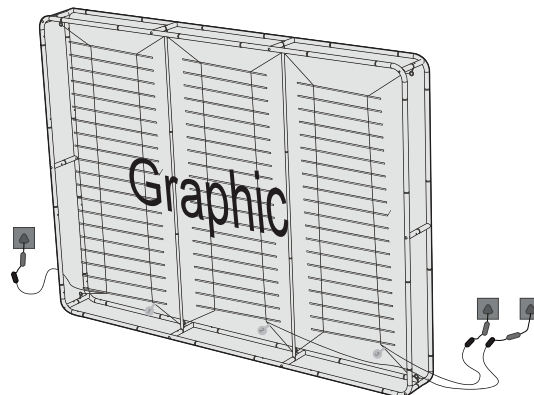

Connect the power to finish.

EXPOSMART

PORTABLE • MODULAR • BETTER

www.exposmart.co.il